

**Grab Rails, Kokanee 60", product number 35007**

**Rails**

The grab rails shall be fabricated of 1.90" O.D. x .065", .109", or .145" wall thickness 304L stainless steel. It shall have four bends that are to be wrinkle free. The grab rails shall be designed for a setback of 60" from pool edge. Sold as an individual rail.

**Anchors and Escutcheons**

The grab rails shall be supported by two (2) 4" bronze wedge anchors and two (2) stainless steel keyhole escutcheons. (Not Included)

**Warranty**

Two year limited warranty.

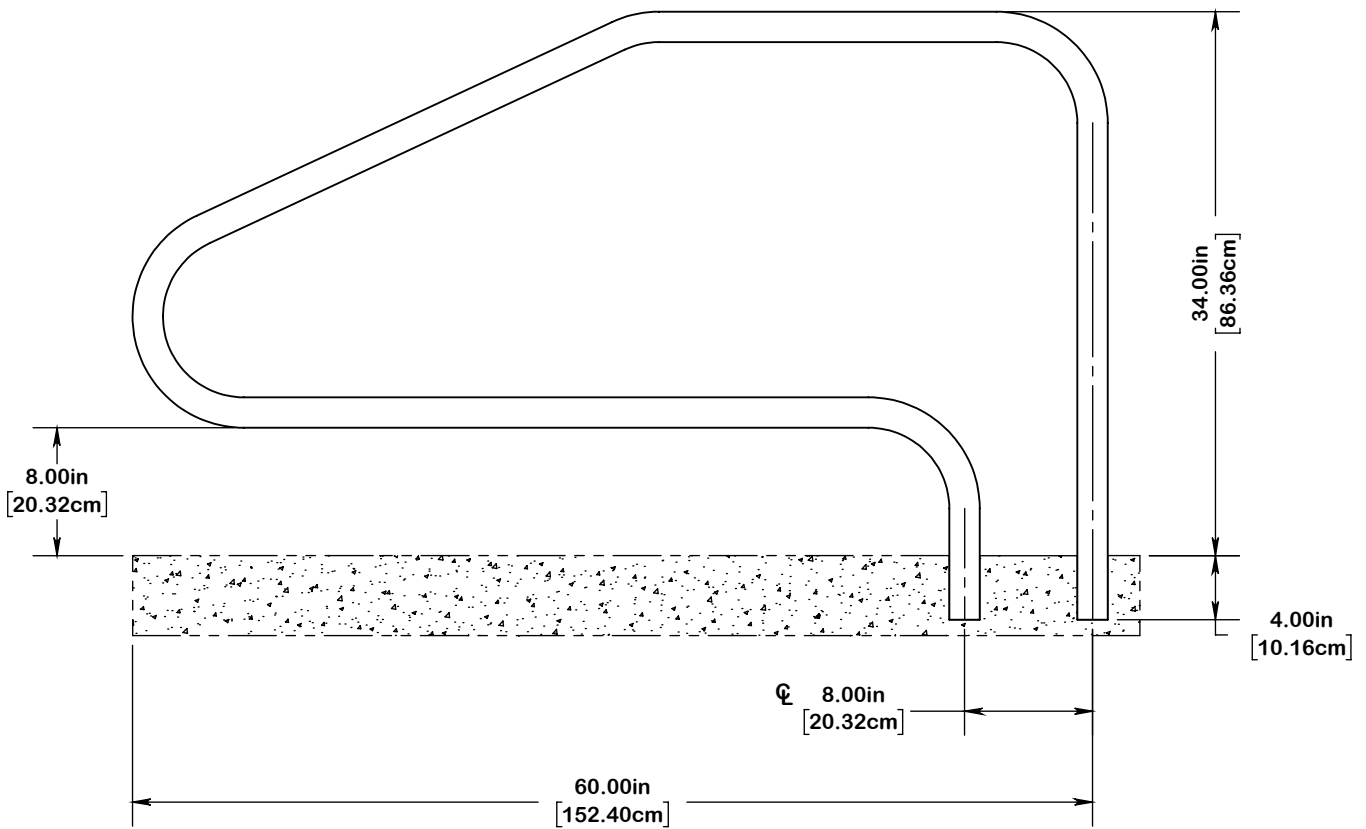
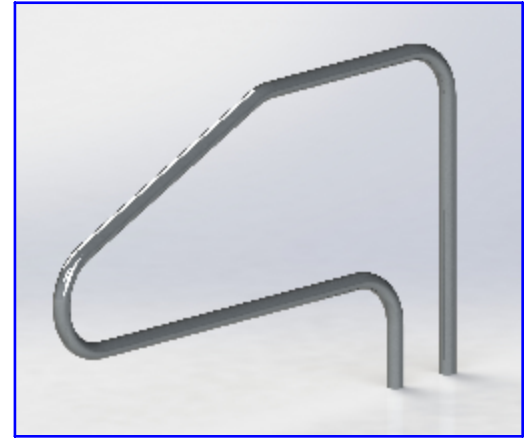

*NOTE:*

*△ DIMENSIONS VARY WITH SPECIFIC APPLICATIONS. SPECIFICATIONS ARE NOMINAL AND ARE SUBJECT TO CHANGE. PLEASE CONTACT SPECTRUM AQUATICS FOR CUSTOM APPLICATIONS*

**SPECTRUM**  
Aquatics

A PLAYCORE Company

7100 Spectrum Lane  
Missoula, Montana 59808  
800.791.8056

www.spectrumaquatics.com

**ENGINEERING DATA**

PRODUCT:	60" KOKANEE - 1.90 -		
MODEL #:	KOKANEE	CATALOG #:	35007
		REVISION:	A
MATERIAL:	STAINLESS STEEL		
FINISH #:	BUFFED TO NEAR #6 FINISH OR 500 GRIT		